

NEW!

Backlight Inductors - DS1608BL Series



These tiny shielded inductors are specially engineered for demanding backlighting applications. They feature high breakdown voltage and exceptional efficiency: DC resistance is 10% to 60% lower than other inductors.

These magnetically shielded inductors are designed with a flat top and constructed of heat resistant materials to ensure trouble-free assembly and reflow operations.

In addition to the standard values shown, custom inductors are also available.

Coilcraft **Designer's Kit C134** contains samples of each of the standard parts shown. To order, contact Coilcraft or visit <http://order.coilcraft.com>.

TYPICAL SATURATION

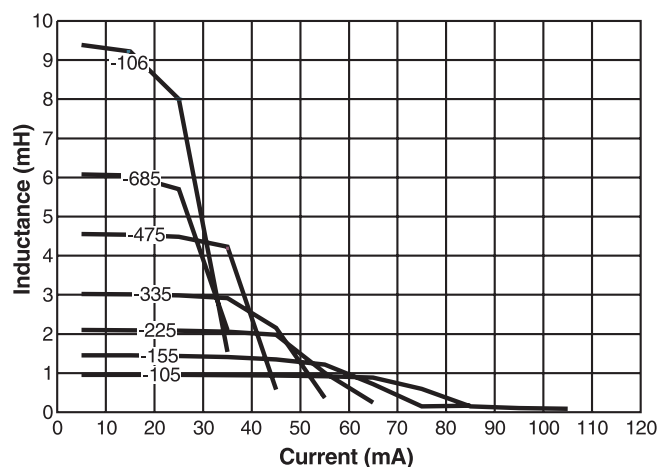

Part number	L $\pm 20\%$ ¹ (mH)	DCR max (Ohms)	Insulation core-winding (MOhms)	SRF typ (MHz)	Current max ² (mA)
DS1608BL-105	1.0	9	>10	2	100
DS1608BL-155	1.5	11	>10	1	80
DS1608BL-225	2.2	19	>10	1	50
DS1608BL-335	3.3	24	>10	1	40
DS1608BL-475	4.7	30	>10	1	30
DS1608BL-685	6.8	56	>10	0.9	20
DS1608BL-106	10.0	74	>10	0.8	10

1. Inductance tested at 0.1 Vrms, 100 kHz.
2. 30° C temperature rise.
3. Operating temperature -40° C to +85° C.
4. Electrical specifications at 25° C.

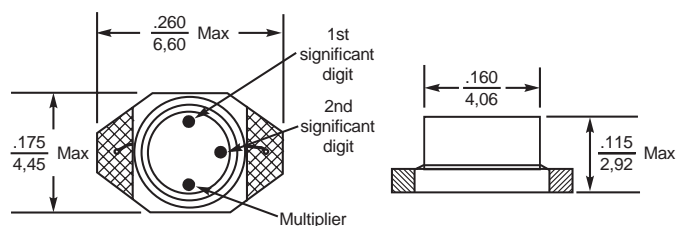

Parts/reel: 7" 750; 13" 2500 Tape width: 12 mm
For packaging data see "Tape and Reel Specifications" section (Doc. 173)

Terminal Pattern

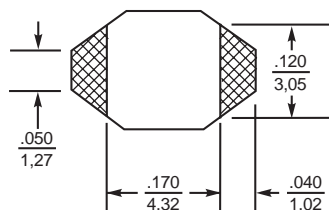

Land Pattern

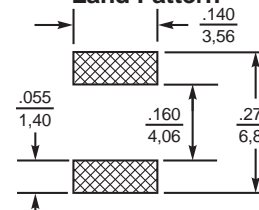

Coilcraft

Specifications subject to change without notice. Document 205 Revised 4/9/99

1102 Silver Lake Road Cary, Illinois 60013 Phone 847/639-6400 Fax 847/639-1469
E-mail info@coilcraft.com Data by Fax 800/651-6974 Web <http://www.coilcraft.com>